



Alcohol and Entertainment Licensing Sub-Committee (B)

Thursday 14 September 2017 at 10.00 am
Members Suite - Brent Civic Centre, Engineers Way,
Wembley, HA9 0FJ

Membership:

Members

Councillors:

Allie (Chair)
Harrison (substituting for Kansagra)
Jones (substituting for Pavey)

Substitute Members

Councillors:

Ahmed, Daly, Denselow, Eniola,
Khan, Long, McLeish, Naheerathan,
Ms Shaw and Stopp

For further information contact: James Kinsella, Governance Services Manager
(020) 8937 2063; james.kinsella@brent.gov.uk

For electronic copies of minutes, reports and agendas, and to be alerted when the minutes of this meeting have been published visit:
democracy.brent.gov.uk

The press and public are welcome to attend this meeting.

Notes for Members - Declarations of Interest:

If a Member is aware they have a Disclosable Pecuniary Interest* in an item of business, they must declare its existence and nature at the start of the meeting or when it becomes apparent and must leave the room without participating in discussion of the item.

If a Member is aware they have a Personal Interest** in an item of business, they must declare its existence and nature at the start of the meeting or when it becomes apparent.

If the Personal Interest is also a Prejudicial Interest (i.e. it affects a financial position or relates to determining of any approval, consent, licence, permission, or registration) then (unless an exception at 14(2) of the Members Code applies), after disclosing the interest to the meeting the Member must leave the room without participating in discussion of the item, except that they may first make representations, answer questions or give evidence relating to the matter, provided that the public are allowed to attend the meeting for those purposes.

***Disclosable Pecuniary Interests:**

- (a) **Employment, etc.** - Any employment, office, trade, profession or vocation carried on for profit gain.
- (b) **Sponsorship** - Any payment or other financial benefit in respect expenses in carrying out duties as a member, or of election; including from a trade union.
- (c) **Contracts** - Any current contract for goods, services or works, between the Councillors or their partner (or a body in which one has a beneficial interest) and the council.
- (d) **Land** - Any beneficial interest in land which is within the council's area.
- (e) **Licences** - Any licence to occupy land in the council's area for a month or longer.
- (f) **Corporate tenancies** - Any tenancy between the council and a body in which the Councillor or their partner have a beneficial interest.
- (g) **Securities** - Any beneficial interest in securities of a body which has a place of business or land in the council's area, if the total nominal value of the securities exceeds £25,000 or one hundredth of the total issued share capital of that body or of any one class of its issued share capital.

****Personal Interests:**

The business relates to or affects:

- (a) Anybody of which you are a member or in a position of general control or management, and:

- To which you are appointed by the council;
- which exercises functions of a public nature;
- which is directed is to charitable purposes;
- whose principal purposes include the influence of public opinion or policy (including a political party of trade union).

- (b) The interests of a person from whom you have received gifts or hospitality of at least £50 as a member in the municipal year;

or

A decision in relation to that business might reasonably be regarded as affecting, to a greater extent than the majority of other council tax payers, ratepayers or inhabitants of the electoral ward affected by the decision, the well-being or financial position of:

- You yourself;
- a member of your family or your friend or any person with whom you have a close association or any person or body who employs or has appointed any of these or in whom they have a beneficial interest in a class of securities exceeding the nominal value of £25,000, or any firm in which they are a partner, or any company of which they are a director
- any body of a type described in (a) above.

Agenda

Introductions, if appropriate.

Item	Page
1 Apologies for absence and clarification of alternate members	
To receive any apologies for absence and substitutions from Members.	
2 Declarations of interests	
Members are invited to declare at this stage of the meeting, any relevant disclosable pecuniary, personal or prejudicial interests in the items on this agenda.	
3 Application for Variation of Premises Licence by Mr Liakath Miah to reflect the following: extend the hours for the sale of alcohol and to remain open from 08:00hrs to 02:00hrs Wednesday to Sunday for the premises know as Stadium Supermarket, 129 Wembley Park Drive, Wembley, HA9 8HQ pursuant to the provisions of the Licensing Act 2003.	1 - 38

Conduct of the Hearing:

The hearing shall proceed as follows:

- General introduction by the Regulatory Services Manager
- Case for the Responsible Authority – Police/Regulatory Services
- Questioning of the Responsible Authority by Applicant and Members
- Representations by interested parties (if any)
- Case for the Applicant
- Questioning of the Applicant by the Responsible Authority and Members
- Summing up by the Responsible Authority
- Summing up by a representative of interested parties (if any)
- Summing up by the Applicant

Members' Deliberation

The Chair will then ask the representatives of the Responsible Authority and the Applicant to leave the meeting room whilst the panel goes into close session to deliberate the application. The applicant and the representatives of the responsible authority will be recalled to the meeting room when the Sub-Committee has made its decision. The decision will be confirmed in writing to the applicant within 7 days



Please remember to switch your mobile phone to silent during the meeting.

- The meeting room is accessible by lift and seats will be provided for members of the public.

This page is intentionally left blank

LICENSING ACT 2003

Application for a Variation to a Premises Licence

1. The Application

Name of Applicant:	Mr Liakath Miah
Name & Address of Premises:	Stadium Supermarket 129 Wembley Park Drive Wembley HA9 8HQ
Applicants Agent:	Rajesh Jagtap

1. Application

The application is to extend the hours of the sale of alcohol and to remain open from 08:00hrs to 02:00hrs Wednesday to Sunday.

2. Background

The premises are currently licensed for the sale of alcohol and to remain open from 09:00hrs to 00:00hrs Monday to Sunday.

3. Promotion of the Licensing Objectives

See separate attachment

4. Relevant Representations

Representations were received and agreed with the Licensing Officers, objections remain outstanding from the Police.

5. Interested Parties

None

6. Policy Considerations

Paragraph Nos: 8.1 – 8.4

8.1 Where responsible authorities and interested parties do not raise any relevant representations regarding the application made to the council, the council will grant the licence or certificate subject only to the conditions that are consistent with the operating schedule or club operating schedule and any mandatory conditions prescribed in the Act itself.

8.2 Where responsible authorities and interested parties raise relevant representations, the council may, if it is satisfied at a hearing or otherwise, impose conditions where considered necessary for the promotion of the licensing objectives.

8.3 Any conditions attached by the council or submitted by the applicant must focus on the direct impact of the activities taking place at licensed premises, on those attending the premises and residents and persons working in the area.

8.4 Any conditions attached to licences will be tailored to the individual needs, style and characteristics of the particular premises and events concerned and will be drawn from a 'model pool of conditions' (where appropriate) to the particular premises.

7. Associated Papers

- A. Copy of Application Form
- B. Copy of Police Representation
- C. Copy of Licensing Representation and withdrawal
- D. Copy of Current Licence
- E. OS Map



APPLICATION TO VARY A PREMISES LICENCE

Application to vary a premises licence
under The Licensing Act 2003

PLEASE READ THE FOLLOWING INSTRUCTIONS FIRST

Before completing this form please read the guidance notes at the end of the form.
If you are completing this form by hand please write legibly in block capitals. In all cases ensure that your answers are inside the boxes and written in black ink. Use additional sheets if necessary.
You may wish to keep a copy of the completed form for your records.

I/We..... MR. LIKATH MIAH.....

..... [insert name of applicant(s)] being the
premises licence holder, apply to vary a premises licence under section 34 of the Licensing
Act 2003 for the premises described in Part 1 below

Premises licence number

223427122

Part 1 – Premises Details

Postal address of premises or, if none, ordnance survey map reference or description

STADIUM SUPERMARKET
129, WEMBLEY PARK DRIVE,
WEMBLEY, MIDDLESEX, U.K

Post Town WEMBLEY

Post Code HA9 8HQ

Telephone number at premises (if any)

Non-domestic rateable value of premises

£ 4920.00

Part 2 - Applicant details

Daytime contact telephone number		[REDACTED]	
E-mail address (optional)		[REDACTED]	
Current postal address if different from premises address		[REDACTED]	
Post Town	LONDON	Post Code	[REDACTED]

Part 3 - Variation

Please tick ☒ Yes

Do you want the proposed variation to have effect as soon as possible?



If not do you want the variation to take effect from

Day Month Year

--	--	--	--	--	--	--	--

Do you want the proposed variation to have effect in relation to the introduction of the late night levy? (Please see guidance note 1)

☐ Yes

☐ No

Please describe briefly the nature of the proposed variation (Please see guidance note 2)

STADIUM A
 SUPERMARKET IS A CONVENIENCE & GROCERY STORE / NEWS AGENCY WOULD LIKE
 TO VARY TO AMEND THE CURRENT SALE OF ALCOHOL HOURS
 FROM 09:00 - 00:00
 TO 08:00 - 02:00 (WEDNESDAY, THURSDAY, FRIDAY, SATURDAY &
 SUNDAY) EVERY WEEK.

CURRENT LICENCE CONTAINS ALL RELEVANT CONDITIONS - REGARDS TO SALE OF
 ALCOHOL
 ON EVENTS DAYS AT THE WEMBLEY (EMIRATES) STADIUM.

- 1) THE SALE OF HIGH STRENGTH BEERS, LARGERS & CIDERS
- 2) AND SECURITY MEASURE FROM ITS ORIGINAL GRANT IN 2015.
 WITH THE PREMISES HAS OPERATING WITHOUT INCIDENT.

If your proposed variation would mean that 5,000 or more people are expected to attend the premises at any one time, please state the number expected to attend

~NA~

Part 4 – Operating Schedule

Please complete those parts of the Operating Schedule below which would be subject to change if this application to vary is successful.

Please tick ✓ Yes

Provision of regulated entertainment (please see guidance note 3)

- | | |
|----------------------------------------------------------------------------------------------------------------|-------------------------------------|
| a) plays (if ticking yes, fill in box A) | <input checked="" type="checkbox"/> |
| b) films (if ticking yes, fill in box B) | <input checked="" type="checkbox"/> |
| c) indoor sporting events (if ticking yes, fill in box C) | <input checked="" type="checkbox"/> |
| d) boxing or wrestling entertainment (if ticking yes, fill in box D) | <input checked="" type="checkbox"/> |
| e) live music (if ticking yes, fill in box E) | <input checked="" type="checkbox"/> |
| f) recorded music (if ticking yes, fill in box F) | <input checked="" type="checkbox"/> |
| g) performances of dance (if ticking yes, fill in box G) | <input checked="" type="checkbox"/> |
| h) anything of a similar description to that falling within (e), (f) or (g)
(if ticking yes, fill in box H) | <input checked="" type="checkbox"/> |

<u>Provision of late night refreshment (if ticking yes, fill in box I)</u>	<input checked="" type="checkbox"/>
----------------------------------------------------------------------------	-------------------------------------

<u>Sale by retail of alcohol (if ticking yes, fill in box J)</u>	<input checked="" type="checkbox"/>
------------------------------------------------------------------	-------------------------------------

In all cases complete boxes K, L and M

A

Plays Standard days and timings (please read guidance note 8)			Will the performance of a play take place indoors or outdoors or both – please tick [✓] (please read guidance note 4).	Indoors	
Day	Start	Finish		Outdoors	
Mon			Please give further details here (please read guidance note 5)	Both	
Tue			State any seasonal variations for performing plays (please read guidance note 6)		
Wed			Non standard timings. Where you intend to use the premises for the performance of plays at different times to those listed in the column on the left, please list (please read guidance note 7)		
Thur					
Fri					
Sat					
Sun					

B

Films Standard days and timings (please read guidance note 8)			Will the exhibition of films take place indoors or outdoors or both – please tick [✓] (please read guidance note 4).	Indoors	
Day	Start	Finish		Outdoors	
Mon			Please give further details here (please read guidance note 5)	Both	
Tue			State any seasonal variations for the exhibition of films (please read guidance note 6)		
Wed			Non standard timings. Where you intend to use the premises for the exhibition of films at different times to those listed in the column on the left, please list (please read guidance note 7)		
Thur					
Fri					
Sat					
Sun					

C

Indoor sporting events Standard days and timings (please read guidance note 8)			Please give further details (please read guidance note 5)
Day	Start	Finish	
Mon			State any seasonal variations for indoor sporting events (please read guidance note 6)
Tue			
Wed			
Thur			Non standard timings. Where you intend to use the premises for indoor sporting events at different times to those listed in the column on the left, please list (please read guidance note 7)
Fri			
Sat			
Sun			

D

Boxing or wrestling entertainments Standard days and timings (please read guidance note 8)			Will the boxing or wrestling entertainment take place indoors or outdoors or both – please tick [✓] (please read guidance note 4).	Indoors	
Day	Start	Finish		Outdoors	
Mon			Please give further details here (please read guidance note 5)	Both	
Tue					
Wed					
Thur			State any seasonal variations for boxing or wrestling entertainment (please read guidance note 6)		
Fri					
Sat					
Sun					
			Non standard timings. Where you intend to use the premises for boxing or wrestling entertainment at different times to those listed in the column on the left, please list (please read guidance note 7)		

E

Live Music Standard days and timings (please read guidance note 8)			Will the performance of live music take place Indoors or outdoors or both – please tick [✓] (please read guidance note 4)	Indoors	
Day	Start	Finish		Outdoors	
Mon			Please give further details here (please read guidance note 5)	Both	
Tue					
Wed					
Thur			State any seasonal variations for the performance of live music (please read guidance note 6)		
Fri					
Sat					
Sun			Non standard timings. Where you intend to use the premises for the performance of live music at different times to those listed in the column on the left, please list (please read guidance note 7)		

F

Recorded music Standard days and timings (please read guidance note 8)			Will the playing of recorded music take place Indoors or outdoors or both – please tick [✓] (please read guidance note 4)	Indoors	
Day	Start	Finish		Outdoors	
Mon			Please give further details here (please read guidance note 5)	Both	
Tue					
Wed					
Thur			State any seasonal variations for playing recorded music (please read guidance note 6)		
Fri					
Sat					
Sun			Non standard timings. Where you intend to use the premises for the playing of recorded music entertainment at different times to those listed in the column on the left, please list (please read guidance note 7)		

G

Performances of dance Standard days and timings (please read guidance note 8)			Will the performance of dance take place indoors or outdoors or both – please tick [✓] (please read guidance note 4).	Indoors	
Day	Start	Finish		Outdoors	
				Both	
Mon			Please give further details here (please read guidance note 5)		
Tue					
Wed			State any seasonal variations for the performance of dance (please read guidance note 6)		
Thur					
Fri			Non standard timings. Where you intend to use the premises for the performance of dance entertainment at different times to those listed in the column on the left, please list (please read guidance note 7)		
Sat					
Sun					

H

Anything of a similar description to that falling within (e), (f) or (g) Standard days and timings (please read guidance note 8)			Please give a description of the type of entertainment you will be providing		
Day	Start	Finish	Will this entertainment take place indoors or outdoors or both – please tick [✓] (please read guidance note 4).	Indoors	
				Outdoors	
				Both	
Mon			Please give further details here (please read guidance note 5)		
Tue					
Wed			State any seasonal variations for entertainment of a similar description to that falling within (e), (f) or (g) (please read guidance note 6)		
Thur					
Fri			Non standard timings. Where you intend to use the premises for the entertainment of similar description to that falling within (e), (f) or (g) at different times to those listed in the column on the left, please list (please read guidance note 7)		
Sat					
Sun					

Late night refreshment Standard days and timings (please read guidance note 8)			Will the provision of late night refreshment take place indoors or outdoors or both – please tick [✓] (please read guidance note 4).	Indoors	
Day	Start	Finish		Outdoors	
Mon			Please give further details here (please read guidance note 5)	Both	
Tue					
Wed			State any seasonal variations for the provision of late night refreshment (please read guidance note 6)		
Thur					
Fri			Non standard timings. Where you intend to use the premises for the provision of late night refreshment at different times, to those listed in the column on the left, please list (please read guidance note 7)		
Sat					
Sun					

Supply of alcohol Standard days and timings (please read guidance note 8)			Will the supply of alcohol be for consumption (Please tick box ✓) (please read guidance note 9)	On the premises	—
Day	Start	Finish		Off the premises	✓
Mon	08:00	00:00	State any seasonal variations for the supply of alcohol (please read guidance note 6)	Both	—
Tue	08:00	00:00			
Wed	08:00	02:00	Non-standard timings. Where you intend to use the premises for the supply of alcohol at different times to those listed in the column on the left, please list (please read guidance note 7)		
Thur	08:00	02:00			
Fri	08:00	02:00			
Sat	08:00	02:00			
Sun	08:00	02:00			

IN ALL CASES PLEASE COMPLETE K, L, & M BELOW

K

Please highlight any adult entertainment or services, activities, other entertainment or matters ancillary to the use of the premises that may give rise to concern in respect of children (please read guidance note 10)

NA-

L

Hours premises are open to the public
Standard days and timings
(please read guidance note 8)

State any seasonal variation (please read guidance note 6)

Day	Start	Finish
Mon	08:00	02:00
Tue	08:00	02:00
Wed	08:00	02:00
Thur	08:00	02:00
Fri	08:00	02:00
Sat	08:00	02:00
Sun	08:00	02:00

Non-standard timings. Where you intend the premises to be open to the public at different times to those listed in the column on the left, please list (please read guidance note 7)

Please identify those conditions currently imposed on the licence which you believe could be removed as a consequence of the proposed variation you are seeking

Please tick ✓ Yes

▪ I have enclosed the premises licence



▪ I have enclosed the relevant part of the premises licence



If you have not ticked one of these boxes please fill in reasons for not including the licence, or part of it, below

Reasons why I have failed to enclose the premises licence or relevant part of premises licence

M Describe any additional steps that you intend to take to promote the four licensing objectives as a result of the proposed variation:

a) General – all four licensing objectives (b, c, d, e) (please read guidance note 11)

PLEASE REFER TO THE ATTACHED SHEET

b) The prevention of crime and disorder

PLEASE REFER TO THE ATTACHED SHEET

c) Public safety

PLEASE REFER TO THE ATTACHED SHEET

d) The prevention of public nuisance

PLEASE REFER TO THE ATTACHED SHEET

e) The protection of children from harm

PLEASE REFER TO THE ATTACHED SHEET.

Please tick ✓ Yes

- I have made or enclosed payment of the fee ☒
- I have not made or enclosed payment of the fee because this application has been made in relation to the introduction of the late night levy ☐
- I have sent copies of this application and the plan to responsible authorities and others where applicable ☒
- I understand that I must now advertise my application ☒
- I have enclosed the premises licence or relevant part of it or explanation ☒
- I understand that if I do not comply with the above requirements my application will be rejected ☒

IT IS AN OFFENCE, UNDER SECTION 158 OF THE LICENSING ACT 2003, TO MAKE A FALSE STATEMENT IN OR IN CONNECTION WITH THIS APPLICATION. THOSE WHO MAKE A FALSE STATEMENT MAY BE LIABLE ON SUMMARY CONVICTION TO A FINE OF ANY AMOUNT.

Part 5 – Signatures (please read guidance note 12)

Signature of applicant (the current premises licence holder) or applicant's solicitor or other duly authorised agent. (Please read guidance note 13). If signing on behalf of the applicant please state in what capacity.

Signature  RAJ JAGTAP
Date 21st JULY 17
Capacity A GENT

Where the premises licence is jointly held signature of 2nd applicant (the current premises licence holder) or 2nd applicant's solicitor or other authorised agent. (Please read guidance note 14). If signing on behalf of the applicant please state in what capacity.

Signature
Date
Capacity

Contact name (where not previously given) and postal address for correspondence associated with this application (please read guidance note 15)	
RAJESH JAGTAP (ARCHITECT-ARB/RIBA) 62 CROWN WALK WEMBLEY HA9 8HU. U.K.	
Post town WEMBLEY - LONDON	Post code HA9 8HU
Telephone number 07961 743174	
If you would prefer us to correspond with you by e-mail your e-mail address (optional) saiarchi@yahoo.com	

SALE OF ALCOHOL OFF THE PREMISES ON
WEDNESDAY , THURSDAY, FRIDAY, SATURDAY & SUNDAY - FROM 08:00 - 02:00AM

Licensing objectives:

Steps we already have in place to promote all four licensing objectives together.
STADIUM SUPERMARKET is general grocery store with all day to day required household items. All precautions & measures are in place on the premises and all adoption of best practice guidance. All premises licensing objectives are achievable in spite of proposed opening hours (23:00 to 02:00)

a) The prevention of crime and disorder

Provision of effective CCTV in and around premises 24hrs/30 days recording
Doors and frames ARE reinforced making it more difficult for intrusion.
Windows that are likely entry points ARE locked and made of toughened glass.
Effective & responsible management of premises. Training & supervision of staff
Provision of secure deposit box. Intruder alarm
Staff Keep a close watch on all customers, especially groups of people and anyone who appears to be loitering.
Provision of litter bins & other security measures, such as lighting outside. Adoption of best practice guidance.
There is a clear view of the whole of your premises at all times. No displays to block your view.
The premises IS well stocked and faced up as this makes it easier to see if items have been removed. Use electronic forged note detector.
Ensure that your staffs understand that as part of our routine security measures their belongings ARE/will be subject to random inspections.
Take great care to check the references of any new staff When employed.

b) Public safety

Suitable & sufficient risk assessments. Easy means of escape on site/premises
Appropriate fire safety devices easily accessible in case of fire (Fire extinguishers)
Regular testing of safety appliance done (and certification). Comprehensive fire risk assessments including occupancy consideration whenever building or operational alterations are carried out at the premises.
Installation of appropriate and adequate safety equipment, warning systems, emergency lighting and evacuation procedures.
Easy access for emergency vehicles, and is free of obstructions at all times.
Fully comprehensive safety checks of all electrical equipment to be undertaken within the premises annually by a competent person and evidenced by certification to National Inspection Council for Electrical Installation Contracting (NICEIC) Standards.
Appropriate instruction, training & supervision of those employed or engaged to secure the safety of the premises.
Effective CCTV in around premises

c) The prevention of public nuisance

Control of noise

Self Manually operated closing main door, adequate false ceiling to concrete 1st floor slab buffer prevents any noise.

Keeping doors and windows closed, especially during periods when TEN is taking place.

No noise pollution. Effective ventilation system on the premises. Area around premises is always clean and tidy.

Control of smells

It is essential that no bad or obnoxious smells come from the premises therefore extraction is in place to be used to ensure the neighbourhood is not offended therE by causing a nuisance.

Proper and sufficient lighting installed, including security lighting in and around the premises

Easy public transport from premises. CCTV operating 24hrs/30 days recording.

Crowd control

Effective queue management, shall be in place incase of crowd, by licensed security staff, to include the prevention of persons after closing time.

d) The protection of children from harm

All/sufficient precautions taken to see children are not exposed to any hazard.

Health & Safety measures are in place where equipment is of danger to young persons.

There is no gambling/adult entertainment.

An exclusion from the premises for 3 hours . After 23:00 till 02:00 and the following morning.

Entry policy will include diligent measures on proof of age.

THE CHALLENGE / CHECK 21/25 SCHEME – NO ID NO SALE!

Effective & responsible management

Sufficient precautions taken to see children are not exposed to any hazard to secure the protection of children from harm.

Compulsory ID checks for under age children's. NO ID NO SALE!

Proper and clear display of Legal Notices.

With all the Safety and Preventive measures all ready in place and being practised for the last 4-years till 23:00 hrs at the present address and Premises for

1) The prevention of crime and disorder

2) Public safety

3) The prevention of public nuisance

4) The protection of children from harm

Four main objectives under the Licensing act 2003. We request you to grant us permission for the EXTRA OPENING Hours as scheduled.

NOTES
THIS DRAWING HAS BEEN BASED ON AN OS MAP
SAI ARCHITECTS & ASSOCIATES. TAKE NO
RESPONSIBILITY FOR THE ACCURACY OF THE
INFORMATION. A FULL DIMENSIONAL AND LEVELS
SURVEY TO BE UNDERTAKEN BEFORE ACCURATE
INFORMATION CAN BE PREPARED



Fire extinguishers



Water



Emergency Lighting



Closed Circuit Television camera



Licensable Activities

EXISTING GROUND
FLOOR PLAN S C A L E 1 : 100

PREMISES LICENCE
VARY -APPLICATION



NOTES:		REVISIONS:	
Figured dimensions are to be used in preference to scaled dimensions. Contractors to verify all dimensions on site before commencing any work or shop drawing.			
Any discrepancies between these drawings and any other documents, drawings and the actual situation encountered on site should be conveyed to SAI Architects & Associates - Consultants and / or contract administrator immediately. This drawing is to be read in conjunction with other issued project documentation and drawings.			
All works to comply with the latest relevant code of practice, British Standards and Building Regulations and are to be the satisfaction of Local Statutory Authorities.			
No part of this drawing may be reproduced without the permission of SAI Architects & Associates. This drawing is to be read in conjunction with other issued project documentation and drawings. Copyright is reserved.			

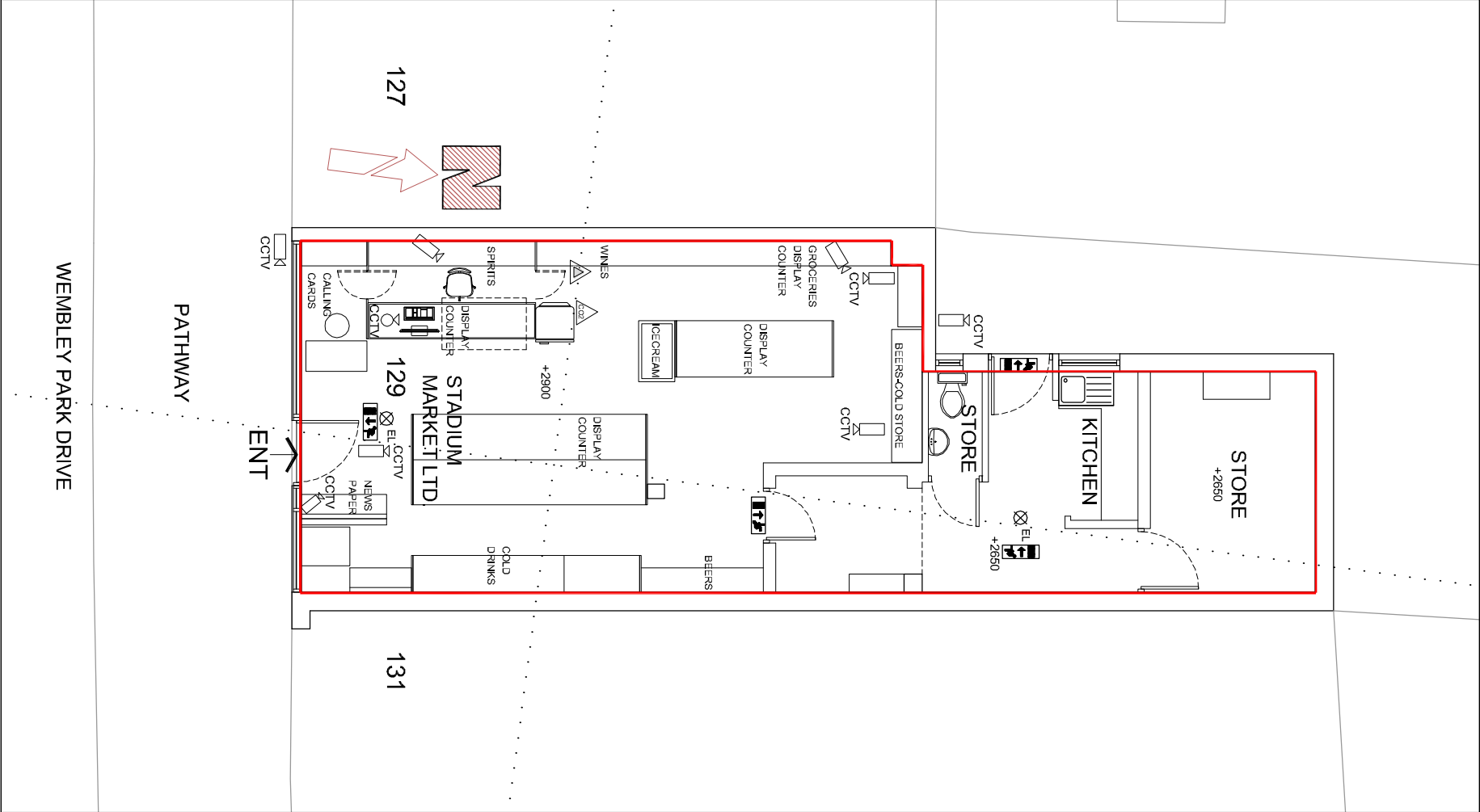

SAI ARCHITECTS &
ASSOCIATES-CONSULTANTS

PROJECT NO.	17/07/PL	DRAWN BY	RJ
DRAWING NO.	17/310/PL	DATE	20/07/17
SCALE	1:100	REV.	*

RIBA (Stage-A) from Inception to (L)-Occupation	
TITLE/VIEW	Existing Floor Plans
PROJECT	Planning - Licence
LOCATION	STADIUM MARKET LTD, 129 Wembley Park Drive, Wembley, London HA9 8HQ

This page is intentionally left blank



**METROPOLITAN
POLICE**

Working together for a safer London

TERRITORIAL POLICING

Brent Police Licensing Unit

*Brent Civic Centre
Engineers Way
Wembley
Middlesex
HA9 0FJ*

Your ref: 223714456

Our ref:

Brent Borough Licensing Department

*Wembley Police Station
603 Harrow Road
Wembley
HA0 2HH*

Tel: 020 8733 3206

Email: michael.sullivan3@met.police.uk

Web: www.met.police.uk

Date: 28th July 2017

Police representation to the Premises Licence application for 'Stadium Supermarket, 129 Wembley Park Drive, Wembley, HA9 8HQ

I certify that I have considered the application shown above and **I wish to make representations** that the likely effect of the grant of the application is detrimental to the Licensing Objectives for the reasons indicated below.

I am of the opinion that the risk to the Licensing objectives can be mitigated by removing the requested variations or attaching conditions to the Licence as shown below.

Officer: Michael Sullivan
Licensing Constable

An officer of the Metropolitan Police, in whose area the premises are situated, who is authorised for the purposes of exercising its statutory function as a 'Responsible Authority' under the Licensing Act 2003.

The application has been made to vary a Premise licence under section 34 of the act.

The Police representations are primarily concerned with **crime and disorder, prevention of public nuisance, and the Protection of Children from Harm.**

An application to vary the Premise Licence of Stadium Super market, 129 Wembley Park Drive HA9 8HQ, asking for an extension of its licensable hours has been submitted. It asks that their hours be extended from 09.00 - 00.00 daily until 08.00 - 02.00 hours daily. On the 28/07/2017 I conducted a visit at the premises, there was one male working in the premises Mr. Srinivasa Gubbala, on checking the licence he is currently shown as the Designated Premises Supervisor for the shop. Mr. Gubbala stated that the owner Mr Liakath was not available, he then asked if he should call the regular guy who works at the shop, I asked him if he worked regularly at the shop and if he was still the DPS as stated on the

licence, he stated that he did work at the shop on a regular basis and that he was the current DPS for the shop, I told him that I was happy for him to assist me as he should be able to answer any questions I had.

He stated he was aware of the application to extend the shops hours, I then informed him that I would be going through the shops current licence conditions.

Condition 1 reads CCTV shall be installed to Home Office guidance standards and maintained in a good working condition and recordings shall be kept for 31 days and shall be made available to police and licensing officers if requested

I asked Mr. Gubbala, if the CCTV was working and if he could show me that it is recording Correctly, I looked at the monitor in the shop and noticed that the times was not correct, I asked him why this was, he stated that it hadn't been changed, he then said that he was unable to work the CCTV.

Condition 4 reads 'A sign stating 'No proof of age - No sale' shall be displayed at the point of Sale.

I looked around the counter area but could not see any sign, I asked Mr. Gubbala, if there was any such sign, he pointed to a sign relating to the sale of cigarettes, I informed him that this was not correct.

Condition 6 reads 'An incident log shall be kept at the premises, and made available for inspection on request to unauthorized officer of Brent Council or the Police, which will record the following;

- (a) all crimes reported to the venue
- (b) all ejections of patrons
- (c) any complaints received
- (d) any faults in the CCTV system
- (e) any refusal of the sale of alcohol
- (f) any visit by relevant authority or emergency service

I asked Mr. Gubbala for the shops Incident log, he had a look for it and said 'shall I call the regular guy' I said 'no you are the DPS you should know where it is' he then conceded that the shop did not have an Incident log book.

Condition 7 reads the following crime prevention measures shall be implemented

A time delay safe with deposit slot and anti-fishing mechanisms must be used at the counter till area.

Regular robbery awareness and cash minimization training shall be given to all staff

I asked Mr Gubbala if the shop had a safe, he stated 'yes' and started to pull up some shelving that was on the floor behind the counter, I asked if the safe was on the floor he then said no its been moved and walked to the rear of the shop and into a store room, he then attempted to open another door but did not know the code, he turned to me and said 'its in here' I asked if it was a time delay safe, he replied 'no'.

Condition 10 reads regular documented staff training on licensing legislation and operating procedures shall be given.

I asked Mr. Gubbala, if I could look at the training documents, he again said 'shall I call the regular guy' I asked him when the last time staff had been trained, he informed me that he had trained the staff a month ago, I asked him what he had trained them in, to which he could not answer.

It is clear from this visit that the shop is poorly managed with numerous breaches to its Current licence conditions, Mr Gubbala, is shown as the DPS for the shop but has very little to no knowledge of the shops licence conditions or the licensing objectives.

I have concerns about the current running of the shop, and would ask that the application to extend its licensable hours be **refused**,

Further to this the shop was issued with a warning letter on the 18th May 2017, after police observed the shop selling glass bottles of alcohol on a Wembley Stadium Event day, breaching condition 8 of its licence condition.

Yours Sincerely,

PC Michael Sullivan 68QK
Licensing Constable Brent Police

This page is intentionally left blank



**METROPOLITAN
POLICE**

Working together for a safer London

TERRITORIAL POLICING

Mr Liakath Miah
c/o Stadium Suoermarket
129 Wembley Park Drive
Wembley
HA9 8HQ
18th May 2017

Brent Police Licensing Unit
Brent Civic Centre
Engineers Way
Wembley
Middlesex HA9 0FJ
Telephone: 020 8733 3206
Mobile: 07824868710
Email:
Nicola.mcdonald@met.police.uk
WEB: www.met.police.uk

Dear Mr Miah

I write to summarise a recent licensing visit made to your premises on Sunday 14th May 2017. On this day it was a designated Wembley Event Day. There was a football match at Wembley Stadium, namely the Vanarama League Final game between Tranmere and Forest Green Rovers. Your shop was open to the public and alcohol was being sold.

During the visit glass bottles of alcohol were being sold and on display for sale. This breaches condition 8 of your premises licence '**on major event days at Wembley Stadium the following should apply: No alcohol or "alcopop" type drinks shall be displayed or sold in glass containers with the exception of wines and spirits.**

It is just as important to maintain this condition on games with lower capacities where sporadic violence is just as common. It is crucial that glass bottles are not accessible and able to be used as weapons

Police insist that the glass bottles are totally covered or removed from display to assist you and your staff from football fans who may persevere in their attempts to purchase them. Glass bottles can cause serious injuries if used as a missile or weapon during disorder.

Contact me on the above email if you have any queries on this matter.

Yours sincerely

Nicola McDonald
Licensing Constable
Brent Police

This page is intentionally left blank

Stadium Supermarket
129 Wembley Park Drive
Wembley
HA9 8HQ

16th August 2017

Our Ref 223727335

Licensing Representation to the Variation Application for the Premises License for Stadium Supermarket, 129 Wembley Park Drive, HA9 8HQ

I certify that I have considered the application shown above and I wish to make a representation.

Officer: Susana Figueiredo – Licensing Inspector

An officer of the Licensing Authority, in whose area the premises are situated, who is authorised for the purposes of exercising its statutory function as a 'Responsible Authority' under the Licensing Act 2003.

The application has been made to vary a premises licence under section 19 of the Act.

The Licensing Authority propose that the following applies;

Conditions to be modified on the Premises Licence

- A CCTV camera shall be installed to cover the entrance of the premises

To be changed to

- A CCTV camera shall be installed to cover the entrance of the premises and further cameras installed to cover the entire serving counter and till.
- Regular documented staff training on licensing legislation and operating procedures shall be given.

To be changed to

- Any staff directly involved in selling alcohol for retail to consumers and managers will undergo training of Licensing Act 2003 legislation. This shall be documented and signed for by the DPS and the member of staff receiving the training. This training log shall be kept on the premises and made available for inspection by police and relevant authorities upon request.

Conditions to be added to the Premises Licence

- A 'Challenge 25' policy shall be adopted and adhered to

I believe the above will add to upholding the Licensing objectives. In order for the Licensing Team to withdraw this representation, it will be necessary for you to confirm the above.

Yours faithfully,



Susana Figueiredo
Licensing Inspector
Planning, Transportation & Licensing

From: Figueiredo, Susana
Sent: 18 August 2017 08:06
To: 'Sai Archi'
Cc: Pramod Kumar Singham; Srinivasrao Gubbala; Lak M14n; Legister, Linda; Business Licence
Subject: STADIUM SUPERMARKET, 129 Wembley Park Drive, Wembley, HA9 8HQ - Reference: 223727335

Dear Rajesh Jagtap,

Thank you for your email and accepting the proposed licensing conditions. I am now withdrawing my representation on the basis that you are representing the applicant as an agent because the name Mr Srinivas Rao Gubbala (DPS) does not relate to the licence holder who applied for the Premises Licence in the first instance.

Dear Business Licence,

Please take this email as confirmation that I am now withdrawing my representation.

Kind Regards

Susana Figueiredo
Licensing Enforcement Officer
Planning, Transportation & Licensing
Brent Council

This page is intentionally left blank

London Borough of Brent

Premises Licence

PART A

*This Premises Licence was granted by Brent Council, Licensing Authority for the area of the Borough of Brent under the **Licensing Act 2003**.*

Signed.....
Head of Regulatory Services

Date: 19 November 2015

Licence number 223427122

Licence start date: 01/11/2015

Part 1 - Premises Details

STADIUM SUPERMARKET, 129 Wembley Park Drive, Wembley, HA9 8HQ
Telephone: ???

Licensable activities and the times authorised by this licence

Supply of Alcohol:

Day	Start Time	End Time
Monday	09:00	00:00
Tuesday	09:00	00:00
Wednesday	09:00	00:00
Thursday	09:00	00:00
Friday	09:00	00:00
Saturday	09:00	00:00
Sunday	09:00	00:00

Seasonal variations: NEW YEAR'S EVE 02:00 THE FOLLOWING DAY/MORNING

Whether alcohol is authorised to be supplied on or off the premises: **Off**

The Opening Hours of the Premises:

Day	Start Time	End Time
Monday	09:00	00:00
Tuesday	09:00	00:00
Wednesday	09:00	00:00
Thursday	09:00	00:00
Friday	09:00	00:00
Saturday	09:00	00:00
Sunday	09:00	00:00

Part 2

Details of Holder of Premises Licence:

Name: Miah, Mr Liakath

Address: [REDACTED]

Details of Designated Premises Supervisor:

Name: MR. SRINIVASA R GUBBALA

Address: [REDACTED]

Telephone: [REDACTED]

Email: [REDACTED]

Personal Licence Number: [REDACTED]

Issuing authority: THE LONDON BOROUGH OF BRENT

Annexe 1 - Mandatory Conditions

Age Verification Policy

(1) The premises licence holder or club premises certificate holder must ensure that an age verification policy is adopted in respect of the premises in relation to the sale or supply of alcohol.

(2) The designated premises supervisor in relation to the premises licence must ensure that the supply of alcohol at the premises is carried on in accordance with the age verification policy.

(3) The policy must require individuals who appear to the responsible person to be under 18 years of age (or such older age as may be specified in the policy) to produce on request, before being served alcohol, identification bearing their photograph, date of birth and either;

(a) a holographic mark, or

(b) an ultraviolet feature.

Minimum Price of Alcohol

1. A relevant person shall ensure that no alcohol is sold or supplied for consumption on or off the premises for a price which is less than the permitted price.

2. For the purposes of the condition set out in paragraph 1;

(a) —duty^{ll} is to be construed in accordance with the Alcoholic Liquor Duties Act 1979;

(b) —permitted price^{ll} is the price found by applying the formula;

$$P = D + (D \times V)$$

where;

(i) P is the permitted price,

(ii) D is the amount of duty chargeable in relation to the alcohol as if the duty were charged on the date of the sale or supply of the alcohol, and

(iii) V is the rate of value added tax chargeable in relation to the alcohol as if the value added tax were charged on the date of the sale or supply of the alcohol;

(c) —relevant person^{ll} means, in relation to premises in respect of which there is in force a premises licence;

(i) the holder of the premises licence,

(ii) the designated premises supervisor (if any) in respect of such a licence, or

(iii) the personal licence holder who makes or authorises a supply of alcohol under such a licence;

(d) —relevant person¹¹ means, in relation to premises in respect of which there is in force a club premises certificate, any member or officer of the club present on the premises in a capacity which enables the member or officer to prevent the supply in question; and

(e) —valued added tax¹² means value added tax charged in accordance with the Value Added Tax Act 1994.

3. Where the permitted price given by Paragraph (b) of paragraph 2 would (apart from this paragraph) not be a whole number of pennies, the price given by that sub-paragraph shall be taken to be the price actually given by that sub- paragraph rounded up to the nearest penny.

4. (1) Sub-paragraph (2) applies where the permitted price given by Paragraph (b) of paragraph 2 on a day (—the first day¹³) would be different from the permitted price on the next day (—the second day¹⁴) as a result of a change to the rate of duty or value added tax.

(2) The permitted price which would apply on the first day applies to sales or supplies of alcohol which take place before the expiry of the period of 14 days beginning on the second day.

Embedded Conditions

Mandatory cont:

Requirement for a DPS

(1) No supply of alcohol may be made under the premises licence-

(a) at a time when there is no designated premises supervisor in respect of the premises licence, or

(b) at a time when the designated premises supervisor does not hold a personal licence or their personal licence is suspended.

(2) Every supply of alcohol under the premises licence must be made or authorised by a person who holds a personal licence.

Door Supervisors and Security Staff to be Licensed by the SIA (Only if required)

Where the licence includes a condition that at specified times one or more individuals must be at the premises to carry out a security activity, each individual must be licensed by the Security Industry Authority, with the following exceptions:

a) premises where the premises licence authorises plays or films

b) any occasion mentioned in paragraph 8(3)(b) or (c) of Schedule 2 to the Private Security Industry Act 2001 (premises being used exclusively by a club with a club premises certificate, under a temporary event notice authorising plays or films or under a gaming licence), or

c) any occasion within paragraph 8(3)(d) of Schedule 2 to the Private Security Industry Act 2001

Annexe 2 - Conditions Consistent With the Operating Schedule

Annexe 3 - Conditions Attached After a Hearing by the Licensing Authority

1 CCTV shall be installed to Home Office Guidance standards and maintained in a good working condition and recordings shall be kept for 31 days and shall be made available to police and licensing officers if requested.

2 A CCTV camera shall be installed to cover the entrance of the premises

3 No high strength beers, lagers, and ciders above 6.0% ABV shall be stocked.

4 A sign stating ¿No proof of age ¿ No sale¿ shall be displayed at the point of sale.

5 A clear and unobstructed view into the premises shall be maintained at all times.

6 An incident log shall be kept at the premises, and made available for inspection on request to an authorised officer of Brent Council or the Police, which will record the following:

- (a) all crimes reported to the venue
- (b) all ejections of patrons
- (c) any complaints received
- (d) any faults in the CCTV system
- (e) any refusal of the sale of alcohol
- (f) any visit by a relevant authority or emergency service

7 The following crime prevention measures shall be implemented:

- ¿ A time delay safe with deposit slot and anti-fishing mechanisms must be used at the counter till area
- ¿ Regular robbery awareness and cash minimisation training shall be given to all staff

8 On major event days at Wembley Stadium the following shall apply:

- ¿ No alcohol or ¿alcopop¿ type drinks shall be displayed or sold in glass containers with the exception of wines and spirits.
- ¿ No more than 4 cans of alcohol shall be sold to an individual.
- ¿ All persons buying alcohol to be advised of the street drinking ban.

9 A copy of the premises licence summary including the hours which licensable activities are permitted shall be visible from the outside of each entrance to the premises.

10 Regular documented staff training on licensing legislation and operating procedures shall be given.

Annexe 4 - Plans

See attached sheet.

LBB - Premises Licence Licence number 223427122

Stadium Supermarket 129 Wembley Park Drive

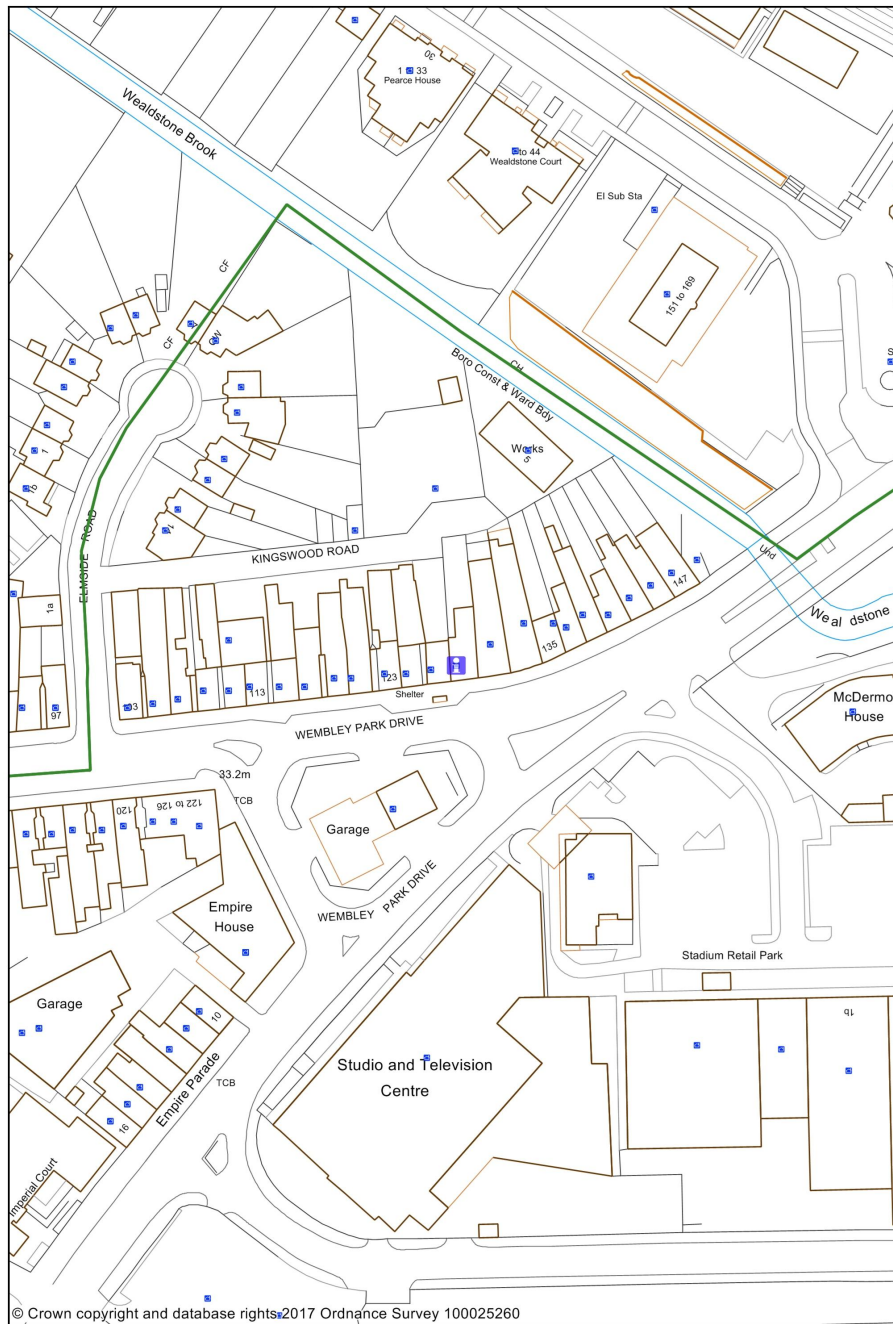

1:1250

0 0.02 0.04 kilometres



Brent

This page is intentionally left blank